

Heritage Door Multipoint Lock - Key Operated

ML130S

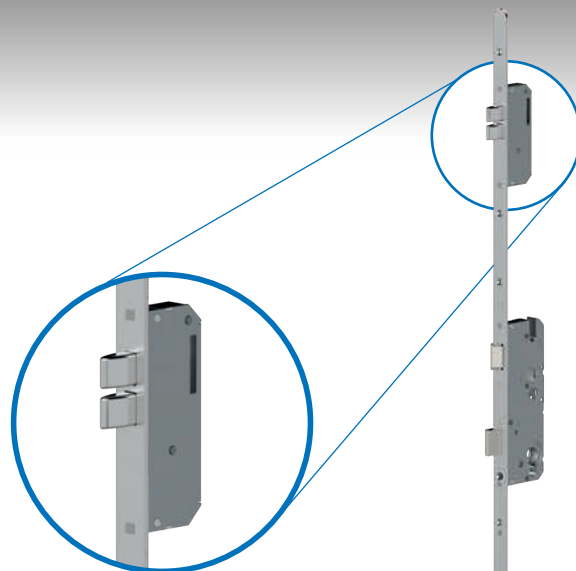
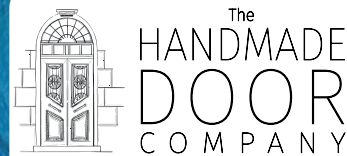

Technical Information:

- 92mm Euro Lock Centre
- 45 or 55mm Backset options
- Universal Lock Handing
(Latch release)

- ▶ 5-Point locking system with twin tapered deadbolts
- ▶ Twin tapered deadbolts provide low operating force, perfect sealing compression and increased weather protection
- ▶ Euro cylinder located at shoulder height to create a Heritage look with modern, secure multipoint locking system
- ▶ Ultra smooth key/thumbturn activated gearbox
- ▶ Turn key 720 degrees to lock/unlock
- ▶ Finished in Silver Bichromate to BS EN 1670:2007 Grade 4



Day Latch feature on keep enables temporary release of locking system allowing easy re-entry e.g. when carrying shopping in from car.



ML130R-45-SV

LIT-MA-DC-ML130R

01444 471 110 | 07861 886 633

gez@thehandmadedoorcompany.com | www.thehandmadedoorcompany.com

Heritage Door Multipoint Lock - Key Operated

What are faceplate widths?

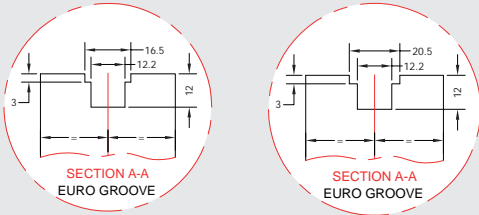

Typical faceplate widths are 16mm or 20mm, this is measured across the face of the lock.

The diagrams above show typical routing detail to suit either the 16mm or 20mm.

How to release the latch on a non-handed (universal) multipoint lock

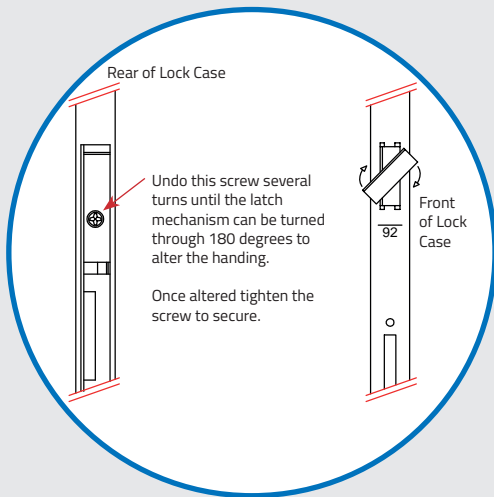

Keep Options:

G



View our Keeps Data Card for more information on the keep options for this multipoint lock

Heritage Door Multipoint Lock - Key Operated

| Part Number | Product | Backset | Units |
|--------------|----------------------------|---------|-------|
| ML130R-45-SV | 20mm Faceplate, Radius end | 45mm | Each |
| ML130R-55-SV | 20mm Faceplate, Radius end | 55mm | Each |

Finish:

SV Silver Passivated

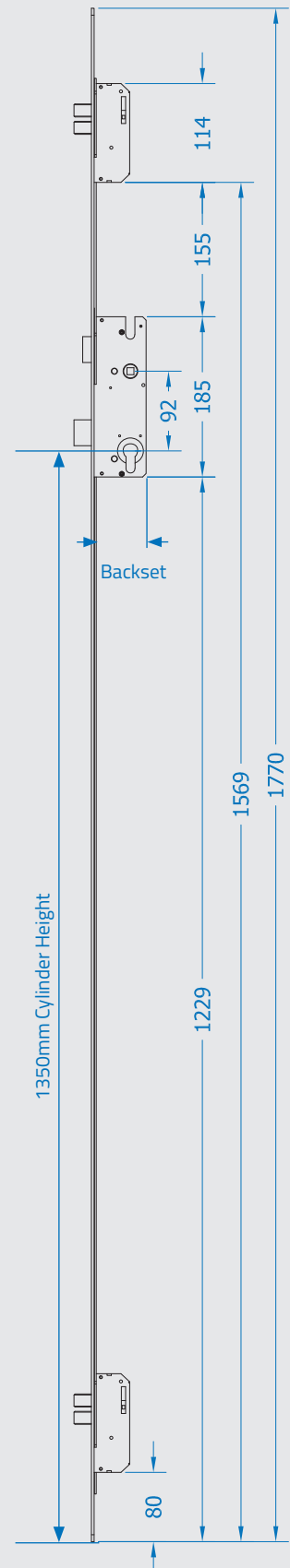

LIT-MA-DC-ML130R

01444 471 110 | 07861 886 633

gez@thehandmadedoorcompany.com | www.thehandmadedoorcompany.com